

# The Tree Town Modelaires

## 59<sup>th</sup> Annual Midwest Regional C/L Championships

AMA Sanction #20173

**Saturday September 5, 2026 - Sunday, September 6, 2026**

**Location: Aurora Municipal Airport, Rt. 30, Sugar Grove, IL 60554**

### Saturday Events:

Stunt Events - (JSO) – Old Time; Classic/N30

**Navy Carrier** – AMA glow and electric classes are combined for Profile, Class 1, Class 2, Skyray and Sportsman. (see special carrier rules)

Class 1 (319,340)(JSO); Class 2 (320,341)(JSO); Profile (321,342)(JSO); Skyray Carrier; (JSO); Sportsman Profile Carrier (JSO)

Note: you may only fly Profile or Sportsman, not both.

### Sunday Events:

#### Precision Aerobatics - PAMPA

323 - Beginner Aerobatics (JSO)

324 - Intermediate Aerobatics (JSO)

325 - Advanced Aerobatics (JSO)

326 - Expert Aerobatics (JSO)

- Profile (engines up to .92) (JSO)

Notes: Beginner, Intermediate and Profile stunt events will be flown over grass

**C/L Scale** 509 - Sport Scale (JSO); 521 - Profile Scale (JSO); 526 - Fun Scale (JSO); 529 - 1/2A Scale (JSO)

**NOTE:** This is the NASA Scale Classic event for 2026. Trophies for this event will be provided by NASA.

**Awards through 3rd Place. Awards for best Junior/Senior in all events.**

#### Entry Fees:

Open, \$10.00 per Event

Junior / Senior, \$5.00 per Event

Competition Begins at 10:00 AM

Registration Closes at 12:00 PM

**\*\* Food, Porta-john and Raffle Available on Site \*\***

#### Lodging:

Comfort Inn, Aurora (630) 820-3400

Hampton Inn, Aurora (630) 907-2600

Holiday Inn, Aurora (630) 806-7400

Holiday Inn Exp., Yorkville (630) 882-0600

Sunset Motel, Yorkville (630) 553-7353

Super 8 Motel, Yorkville (630) 553-1634

#### Contest Director:

Jim Schuett, AMA 54705

2350 Sans Souci Drive,

Aurora, IL. 60506

Phone: (630) 642-3617 E-Mail: [Jschuett25@comcast.net](mailto:Jschuett25@comcast.net)

#### \*ATTENTION\*

**No Alcoholic Beverages** are allowed at the Airport. Violators will be escorted off site by irate club members and / or the **Sugar Grove Police**.

There will be **No Refunds**, regardless of Weather or other circumstances.

The Aurora airport is located on the North side of Hwy 30, approximately ½ mile West of Hwy 47 in the town of Sugar Grove.

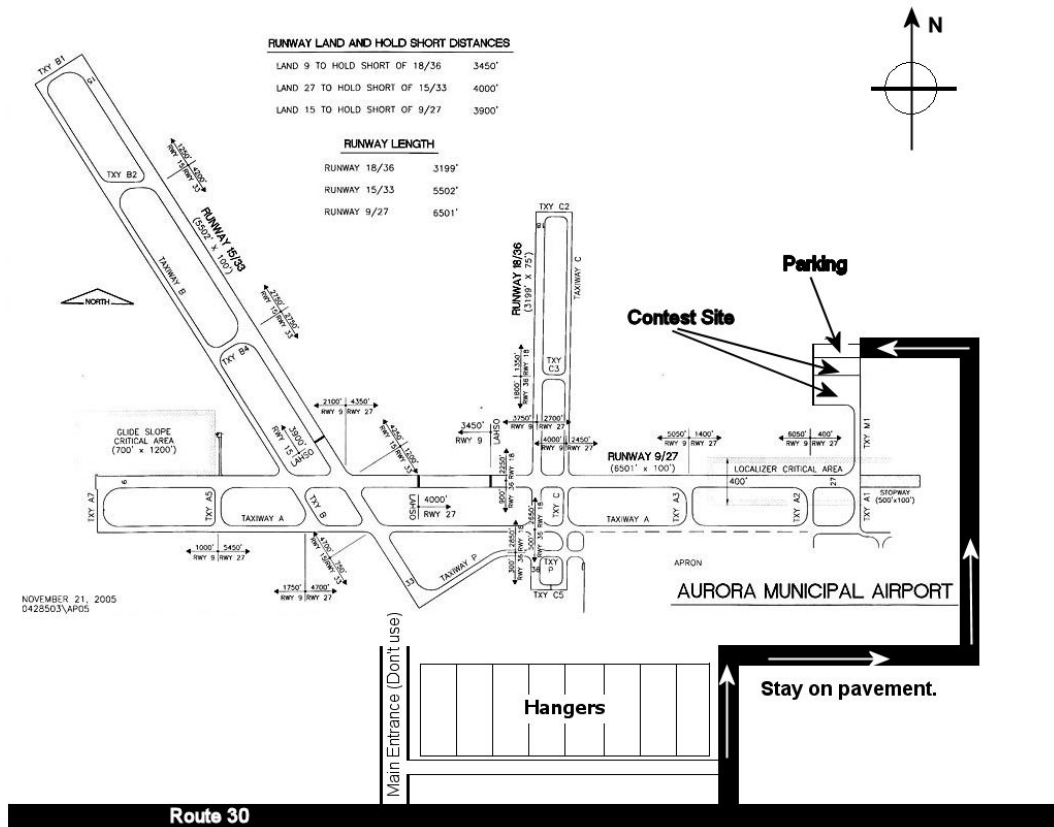
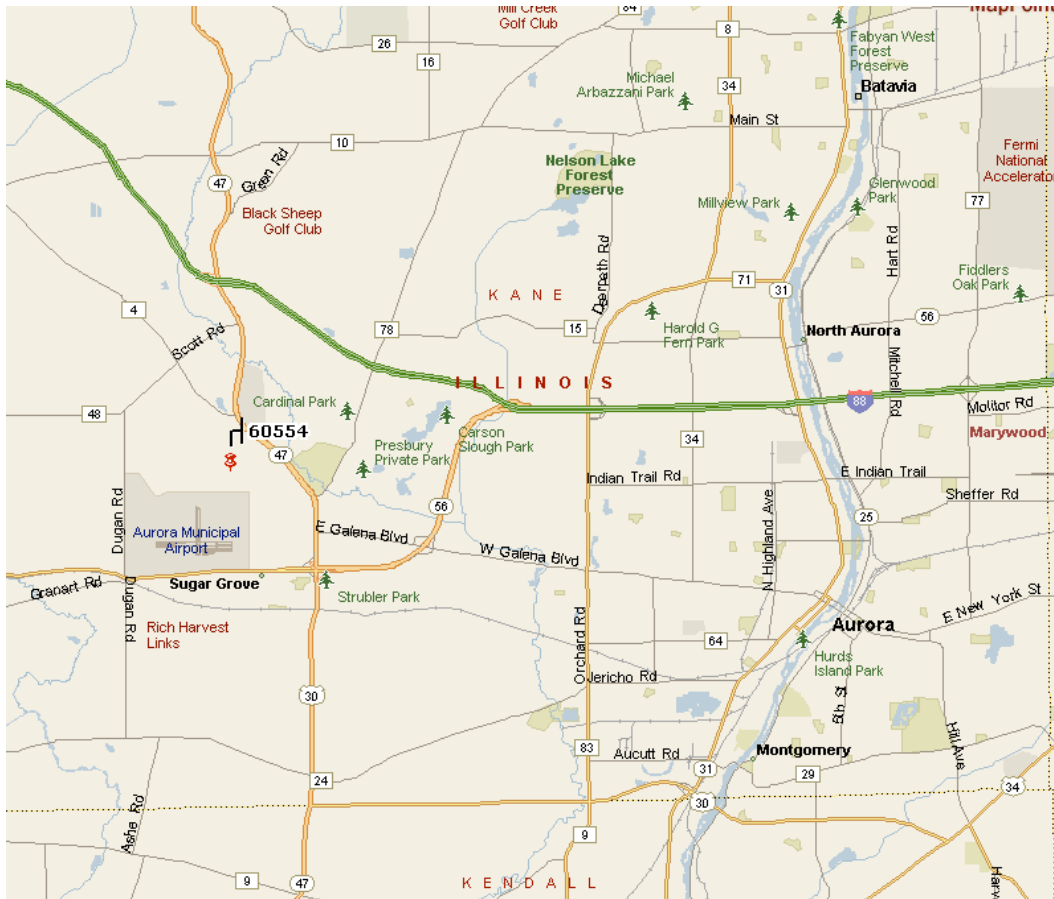

**Special Rules for the Tree Town Modelaires  
Midwest Regional Championships:**

***All appropriate AMA safety rules apply to these events -***

**Sportsman Carrier:** Same rules as Profile Carrier (gas and electric combined). This class is intended for "Sportsman" entrants who do not wish to compete in the "Open" Profile Carrier Class. The event director reserves the right to promote an entrant to the "Open" profile carrier class based on performance. No person may enter both Profile and Sportsman, however Sportsman entrants may also enter Class I, Class II and Skyray events.

**Skyray Carrier:**

- 1) SIG Skyray 35 kit or accurate reproduction only. Although construction details may be modified, wing and empennage airfoils and outlines of fuselage and flight surfaces shall be stock within normal building tolerances.
  - a. No additional movable flight control surfaces are allowed other than elevator. The chord of the elevator may be increased from stock.
  - b. Two-wheel landing gear is allowed. Tail skid may be modified. Motor mounts (and fuselage front end) may be modified in a reasonable way to accommodate the motors being used, but not for additional streamlining.
  - c. Either a standard 3-line control system (elevator and throttle) or a 2-line control system for elevator with throttle (and options such as hook release) controlled by either an electrical signal passing through the lines or by a 2.4Ghz radio signal. Design and location of control system components is open.
  - d. Repositioning the lead-outs to a location on the wing tip other than where shown on the plan is allowed as long as the lead-outs emerge from the wing tip within the fore-aft limits of the wing. Line sliders are NOT allowed. Stock wing tips may be left off - no further shortening of the wing is allowed.
  - e. Addition of arresting hook is allowed.
- 2) Propulsion system may be either piston engine (glow) or electric motor. Maximum displacement for piston engine is .409 cu.in. (muffler optional).
- 3) Fuel Tank: Suction only, no pressurized systems.
- 4) Fuel: SIG Champion 10% (supplied at contest).
- 5) The scoring of the event shall be per the AMA rule book for Profile Carrier with the following exceptions:
  - a. No scale bonus points will be awarded, however the model should look like a SIG Skyray 35.
  - b. Maximum high speed score will be limited to 75 mph
- 6) All other rules are the same as for AMA Profile Carrier and the AMA Electric Profile event, whichever is appropriate.

**Profile Stunt:**

- 1) PAMPA Stunt flown with a profile airplane,
- 2) Any size (up to .92 cu. In.) engine allowed.
- 3) Must adhere to AMA general control line rules for profile airplanes.
- 4) All competitors fly one class.
- 5) Event will be flown off a grass circle.